

Dimensions drawing:

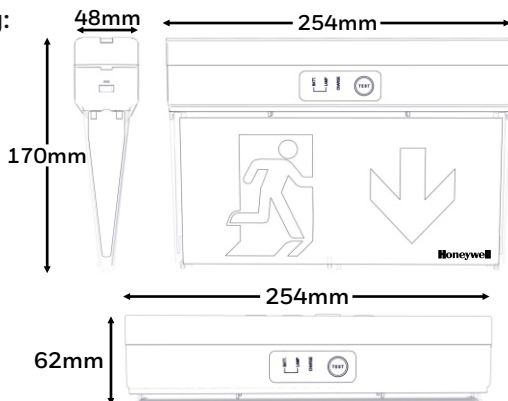

## Common Installation Steps:

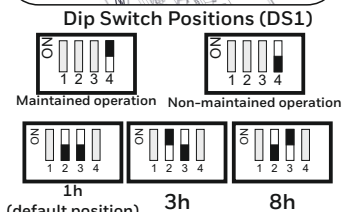
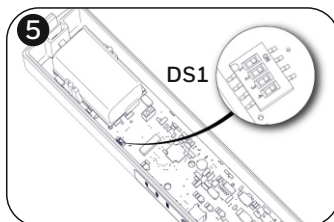
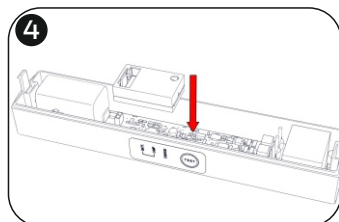
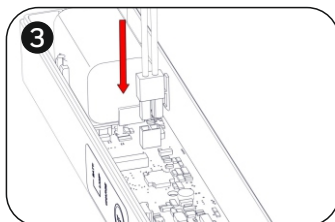
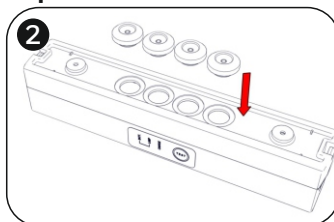
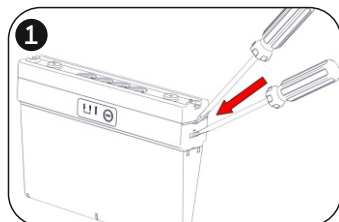

**MultiLED can be used as an emergency luminaire or an exit sign. See the next page for mounting methods. Below some common steps to follow.**

**Step 1:** Place a flat blade screwdriver to remove the transparent legend and the top cover from the main body by pressing gently on the retaining clips as shown in picture.

**Step 2:** Install the four included cable gaskets into the cable entry holes (verify that is not deformed).

**Step 3:** Connect the battery cable to its respective connector on the PCB.

**Step 4:** In case you use a module connect it on the PCB.

**Step 5:** The control of maintained or non maintained operation of the luminaire is achieved through Switch 4 of DS1. For maintained operation, switch number 4 must be in ON position. For non-maintained operation, switch number 4 must be in OFF position.

The user can select one of the 3 available minimum autonomy durations: 1 hour, 3 hours and 8 hours. The selection must be done while the luminaire is disconnected from AC and battery supplies. The selection is achieved through Switches 2 & 3 of DS1. Switch 1 is not used.

Two additional labels are included in the package, one for 3 hours duration (180) and one for 8 hour duration (480). Depending on the selected duration, the installer must cover the default 1 hour (60) printing with one that has the required duration.

**Please take notice of the orientation of the label.**

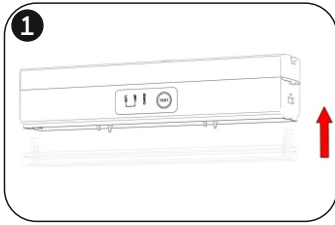

**Step 1:** To use MultiLED as an emergency luminaire, install the provided lens.

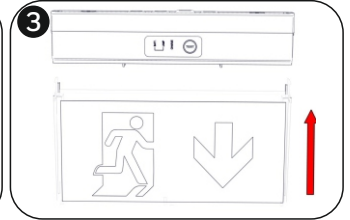
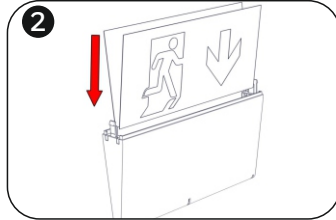
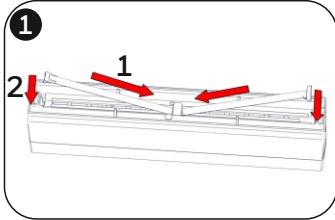

- Step 1:** To use MultiLED as an exit sign, install the provided two lens, mind the correct orientation, as show in picture 1.
- Step 2:** For double sided pictogram, install the appropriate pictograms to both sides. For single sided pictogram, there is one blind pictogram in the package.
- Step 3:** Install the the transparent legend with the pictograms to the luminaire's base.

## Mounting Methods

### Ceiling Mounting

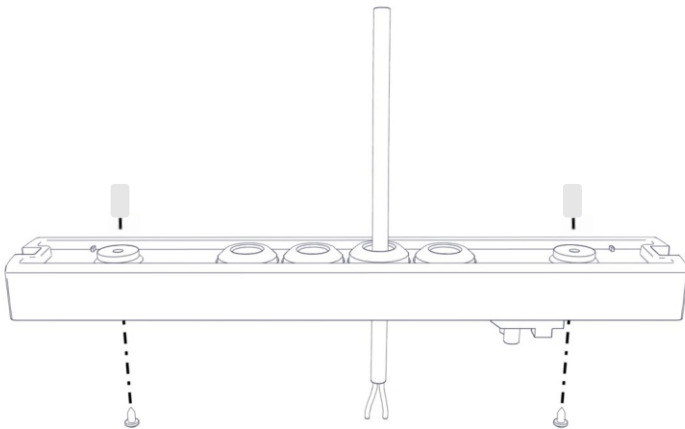

**Installation:**

Make a hole into the desired gasket by using a small screwdriver. Pass the round cable through the gasket. Install the luminaire top cover on the ceiling with the included mounting parts.

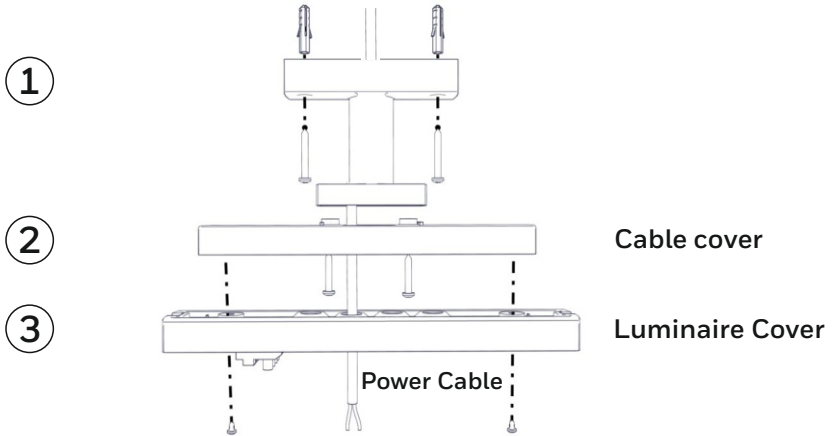
**Hanging Mounting**

**Step 1:** Pass the cables through the hanging accessory and install it on the ceiling with the included mounting parts.

**Step 2:** Screw the cable cover on the hanging accessory with the two included mounting screws and pass through the power cable.

**Step 3:** Screw the luminaire cover to the cable cover with the two included mounting screws and pass through the power cable.

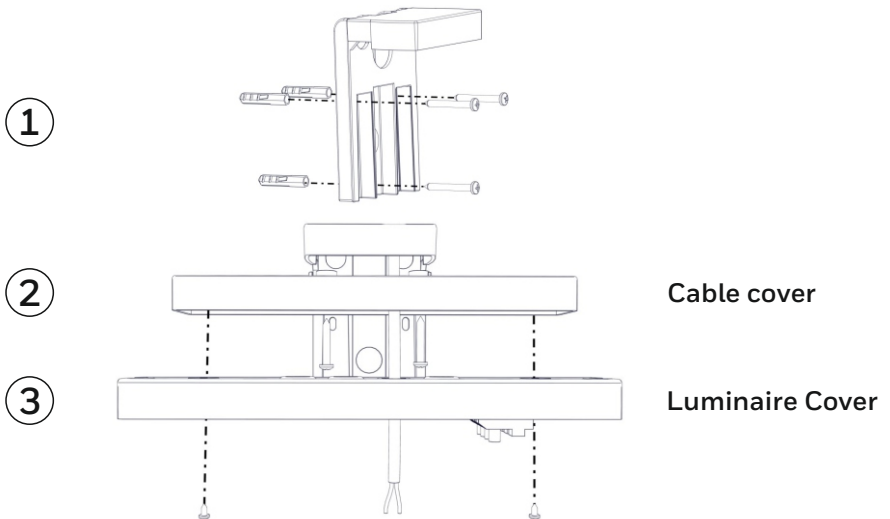
**Surface mounting on the wall**

**Step 1:** Pass the cables through the plastic bracket and install it on the wall with the included mounting parts.

**Step 2:** Screw the cable cover on the plastic bracket with the two included mounting screws and pass through the power cable.

**Step 3:** Screw the luminaire cover to the cable cover with the two included mounting screws and pass through the power cable.

### Flag Bracket Mounting (Optional After Request Part No.298100.1)

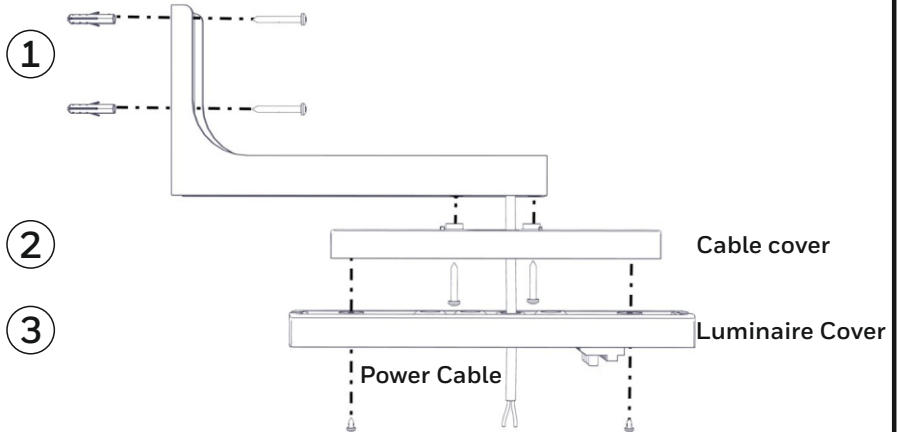

**Step 1:** Pass the cables through the flag bracket and install it on the wall with the included mounting parts.

**Step 2:** Screw the cable cover on the flag bracket with the two included mounting screws and pass through the power cable.

**Step 3:** Screw the luminaire cover to the cable cover with the two included mounting screws and pass through the power cable.

### After the desired mounting methods, follow the steps bellow

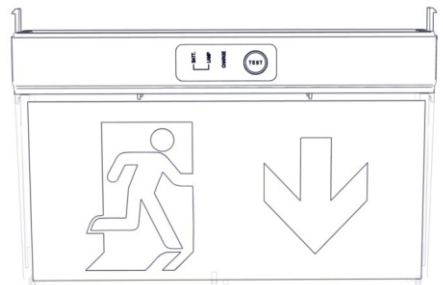
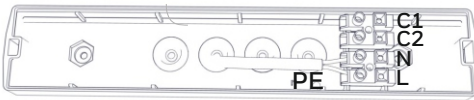

Connect the main cables to the respective terminal block. **N** for neutral, **L** for live wire and **PE** (optional) for ground wire. The **C1** and **C2** terminals are used for elBus communication (optional), DALI communication (optional) or voltage free contact (optional). Always use in any case round mains cable, with a diameter of 5–10mm (H05RN-F type 2x1mm<sup>2</sup> or any other type, at least equal to it's mechanical and electrical properties). **ATTENTION!!** The cable must not be deformed in any way (This requirement is important to ensure the IP rating).

**Push the plastic base of the luminaire to the luminaire's cover.**

Technical description	MultiLED Combi ST LED 230V wpict 138h
Part no.:	138008
Operation Voltage:	220-240V AC, 50-60 Hz
Maximum Power Consumption:	5W / 5.2V
Battery (NiMH):	4.8V / 1.2Ah
Battery Protection:	Overcharge protection / Deep discharge protection
Min./Max. Charge Current:	40 / 140mA
Charge Voltage Range:	4-6V
Charging Time:	16 hours
Emergency Mode Duration:	1h / 3h / 8h manually selected (default 1h)
Lumen output, normal:	275lm
Lumen output, emergency (1h/3h/8h):	340 / 155 / 60lm
Produced in accordance with:	EN 60598-1, EN 60598-2-22, EN 55015 EN 61547, EN 61000-3-2, EN 61000-3-3
Ambient Temperature Range:	5 to 40 °C
Relative Humidity:	Up to 95%
Degree of cover protection:	IP44
Technical lifetime (light source):	> 100000 hours
Weight:	610 gr
Expected Battery Lifetime:	4 years
Controlgear classification in accordance with IEC 62034:	with automatic test function

In case that the luminaire no longer meets its rated duration of operation, the battery must be replaced.

#### Battery Replacement:

Disconnect mains, carefully remove the luminaire from the ceiling or wall. Dismantle the luminaire. Disconnect the battery and install a new one of the same type and characteristics.

**Note:** In case of battery replacement, this must be replaced with parts of the same type and characteristics. The replacement must be performed by the manufacturer of a competent person.

**Note:** If the supply cable of the luminaire is damaged, it shall exclusively be replaced by a competent person in order to avoid hazard.

**Note:** In case of mains power disconnection for a period of more than two months, the battery must be disconnected.

#### Important notice when installing luminaires within the same area!!!

























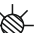

To avoid that luminaires perform their battery test at the same day, connect the battery packs with more than 1,5 minutes inbetween.

 The light source contained in this luminaire shall only be replaced by the manufacturer, or his agent, or a similar qualified person.

**NOTE!** The light source is non-user replaceable.

 At the end of their useful life the packaging, product and batteries should be disposed of via a suitable recycling centre. Do not dispose of with your normal household waste. Do not burn.



Indicator LEDs	Description
<div style="display: flex; justify-content: space-around;"> <div style="text-align: center;">GREEN </div> <div style="text-align: center;">YELLOW </div> <div style="text-align: center;">RED </div> </div>	Normal
<div style="display: flex; justify-content: space-around;"> <div style="text-align: center;"></div> <div style="text-align: center;"></div> <div style="text-align: center;"></div> </div>	Charging (battery test not possible while charging)
<div style="display: flex; justify-content: space-around;"> <div style="text-align: center;"></div> <div style="text-align: center;"></div> <div style="text-align: center;"></div> </div>	Mains off, battery not connected or charger fault
<div style="display: flex; justify-content: space-around;"> <div style="text-align: center;"></div> <div style="text-align: center;"></div> <div style="text-align: center;"></div> </div>	Battery test
<div style="display: flex; justify-content: space-around;"> <div style="text-align: center;"></div> <div style="text-align: center;"></div> <div style="text-align: center;"></div> </div>	Battery fault
<div style="display: flex; justify-content: space-around;"> <div style="text-align: center;"></div> <div style="text-align: center;"></div> <div style="text-align: center;"></div> </div>	Light source test
<div style="display: flex; justify-content: space-around;"> <div style="text-align: center;"></div> <div style="text-align: center;"></div> <div style="text-align: center;"></div> </div>	Light source fault
<div style="display: flex; justify-content: space-around;"> <div style="text-align: center;"></div> <div style="text-align: center;"></div> <div style="text-align: center;"></div> </div>	Battery fault and light source fault
LED Status explanation	
 Off	 On
 Flashing	

The MultiLED is a self-contained maintained/non-maintained luminaire with selftest function.

**Selftest functions**

Every 15 days the luminaire will perform an emergency operation test. This will turn on the light source for approximately 3 seconds. The red LED will flash during this test sequence.

Every 6 months the luminaire will perform a battery condition test. The test will last for the chosen autonomy. The light source will be lit and the yellow LED will flash during this test sequence.

**Note:** When using DALI or Wireless communication, the frequencies and schedules for tests will instead be determined by the connected PC software.

**Manual test functions**

Manual tests can only be performed if both mains and battery are connected.

By pressing the test button briefly (less than 5 seconds) an emergency operation test is performed. The light source will be lit for approximately 3 seconds, the red LED will flash during this test sequence.

By pressing the test button for between 5 and 10 seconds a battery condition test is performed. This test will last for the chosen autonomy and can only be performed when the battery is fully charged (steady green LED). The light source will be lit and the yellow LED will flash during this test sequence.

**Resetting errors**

Push the test button for more than 10 seconds to delete all indicated errors. Then the luminaire enters regular operation mode.

**Dimming**

By pressing the test button continuously > 15 seconds, when luminaire is connected to mains, the luminosity will be reduced to 10% of its total luminance. In emergency mode the light output will remain unchanged.

To restore the original settings, repeat the above procedure.

The dimming setting remains stored in the luminaire even when both mains and battery voltages are disconnected.