

### Dimensional Drawings:

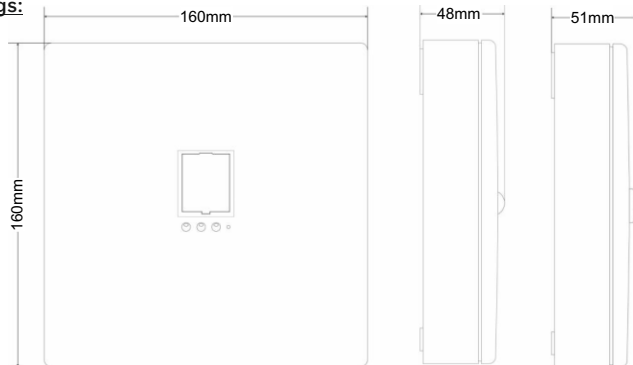

### Installation:

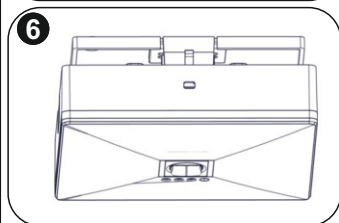
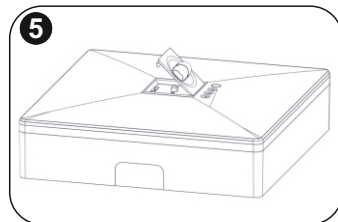
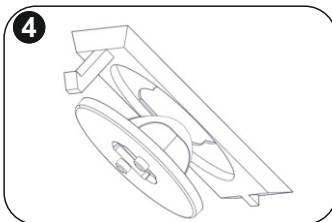
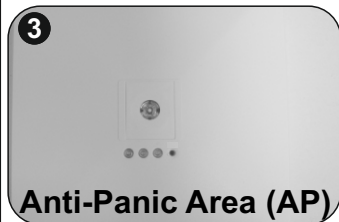
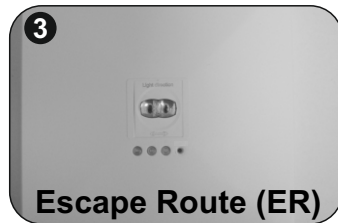
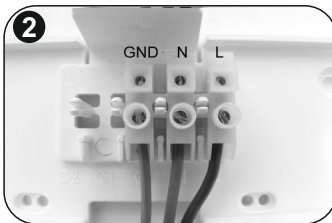
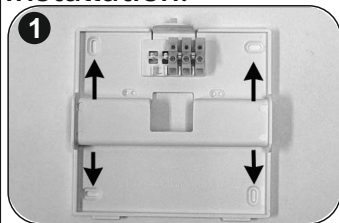

**Disassembly:** Press the plastic hook (picture 4) using e.g. a screwdriver and carefully pull the luminaire down.

**Step 1:** Mount the socket, make sure that the light direction is correct (marked in socket).

**Step 2:** Connect the mains cables L, N and GND (optional) to the terminal block. Power supply cables cross section should be 0.8 – 3 mm<sup>2</sup>.

**Step 3:** In order to place the proper lens (Anti - panic or escape route), first be sure that the luminaire is not connected to the power supply. A 5 lux lens (Part no. 2900XX.STR) is also available for order. Use the corresponding lens retaining cover depending on the lens you will use.

**Step 4:** Put the lens on the retaining cover.

**Step 5:** Insert the cover with the lens on the luminaire. Be carefull not to touch the LED with your hand.

**Step 6:** Hook the luminaire to the two notches in the socket and push carefully until the plastic hook locks.

Technical description	Ova-OmniLED NM LED 230V Centralized
Part no.:	138376
Operation Voltage:	100-265V AC/DC, 50-60 Hz
Maximum Power Consumption:	3.5W / 3.75VA
Lumen output:	270 lm
Produced in accordance with:	EN 60598-1, EN 60598-2-22
Ambient Temperature Range:	-30 to 50 °C
Relative Humidity:	Up to 95%
Degree of cover protection:	IP20
Technical lifetime (light source):	> 100000 hours
Weight:	400 gr



At the end of their useful life the packaging and product should be disposed of via a suitable recycling centre.  
Do not dispose of with your normal household waste.  
Do not burn.



The light source contained in this luminary shall only be replaced by the manufacturer, or his agent, or a similar qualified person.

*NOTE! The light source is non-user replaceable.*