

### Installation:

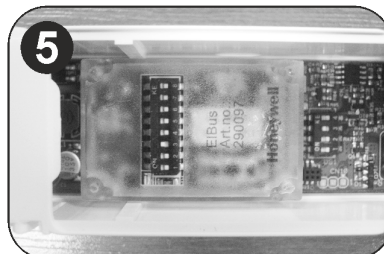
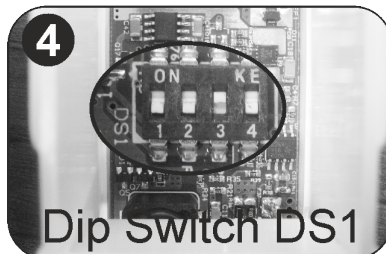
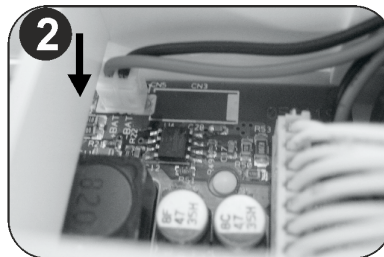
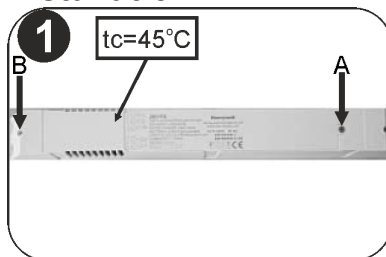

To install this luminaire, a hole Ø 70 mm must be cut in the suspended ceiling. For correct mounting, observe the light direction

**Step 1:** Unfasten the mounting screws, **A** for battery compartment and **B** for electrical connections. Remove the respective covers.

**Step 2:** Connect the battery and place the battery inside the compartment. Refit the cover and fasten the removed screw (**A**) in step 1.

**Step 3:** Connect the mains cables to the terminal blocks. **L** for live wire **N** for neutral. The ground terminal is optional. Power supply cables cross section should be 0.8 – 3 mm<sup>2</sup>. The **C1** and **C2** terminals are used for elBus communication (optional), DALI communication (optional) or voltage free contact (optional). After the connection of the cables, secure them with the provided ties. Refit the cover (**B**) and fasten the removed screw in step 1.

**Step 4:** The user can select one of the 3 available minimum autonomy durations: 1 hour, 3 hours and 8 hours. The selection must be done while the luminaire is disconnected from AC and battery supplies. The selection is achieved through Switches 2 & 3 of DS1 according to image below. Switches 1 and 4 are not used.

Two additional labels are included in the package, one for 3 hours duration (180) and one for 8 hour duration (480). Depending on the selected duration, the installer must cover the default 1 hour (60) printing with one label that has the required duration. Please take notice of the orientation of the label.

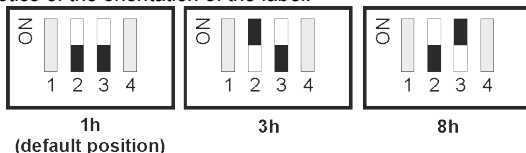

**Step 5:** In case you use a module connect it on the PCB.

**Note:** In case of mains power disconnection for a period of more than two months, the battery must be disconnected.

**Important notice when installing luminaires within the same area!!!**

To avoid that luminaires perform their battery test at the same day, connect the battery packs with more than 1,5 minutes inbetween.

### Battery replacement:

Disconnect mains, carefully pull the luminaire and main unit down, make sure that the springs do not snap. Unscrew the battery cover (step 1, screw **A**). Disconnect the battery and install a new one of the same type and characteristics. Refit the cover and fasten the screw.

## Spot Installation

Place the main unit on the false ceiling and follow the next steps.

**Step 1:** Bend one spring, to get into the holes of the suspended ceiling.

**Step 2:** Bend the other spring and push the luminaire upwards until it is securely mounted.

**Step 3:** The device is now ready to operate. The TEST button is located next to the indication diodes.

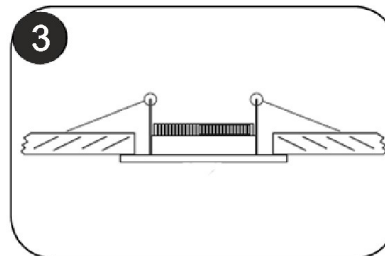
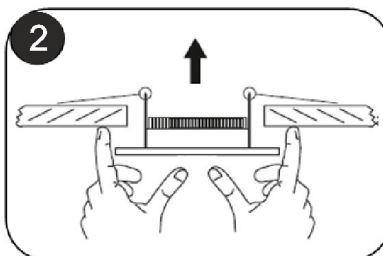
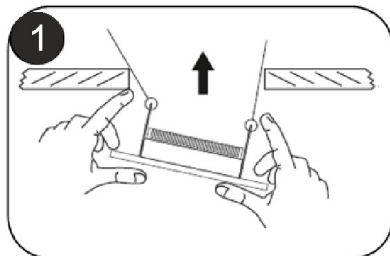

## LENS PLACEMENT









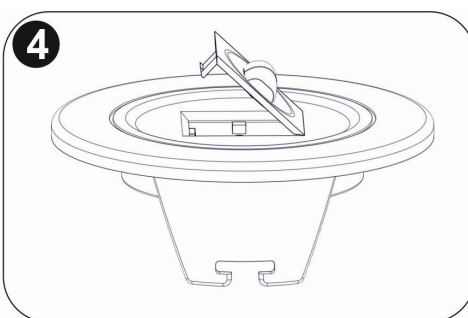
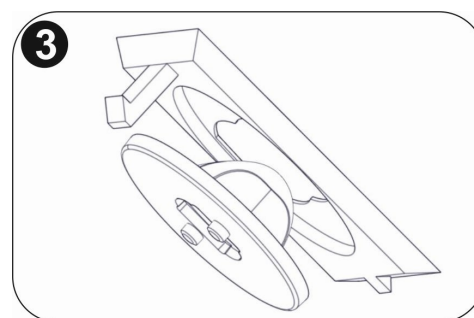



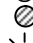









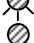
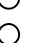

**Step 1:** In order to place the proper lens (Anti - panic or escape route), first be sure that the luminary is not connected in the mains power supply and the battery is disconnected.

**Step 2:** Use the corresponding lens retaining cover depending on the lens you will use.



**Step 3:** Put the lens on the retaining cover.

**Step 4:** Insert the cover with the lens on the luminary. Be carefull not to touch the LED with your hand.

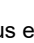

| Indicator LEDs   | Description   |
|--|---|
|  GREEN<br> YELLOW<br> RED |   |
|                           | Normal  |
|                           | Charging (battery test not possible while charging) |
|                           | Mains off, battery not connected or charger fault   |
|                           | Battery test  |
|                           | Battery fault                                       |
|                           | Light source test                                   |
|                           | Light source fault                                  |
|                           | Battery fault and light source fault                |

#### LED status explanation

 Off   
 On   
 Flashing

**At the end of their useful life the packaging, product and batteries should be disposed of via a suitable recycling centre. Do not dispose of with your normal household waste. Do not burn.**



| Technical description   | Ova-OmniLED R Spot ER AP NM ST LED 230V 138h                              |
|---|---|
| Part no.:   | 138007  |
| Lumen output (1/3/8h):  | 360 / 170 / 70 lm   |
| Maximum power consumption:  | 3.5W / 3.9V   |
| Operation voltage:  | 220-240VAC 50/60Hz  |
| Emergency mode duration:  | 1 h / 3h / 8h manually selected (default 1h)                              |
| Battery:  | 4.8V / 1.2Ah NiMH   |
| Battery protection:   | Over charge protection / deep discharge protection                        |
| MIN./MAX. Charge Current:   | 40 / 120 mA   |
| Charge Voltage Range:   | 4-6V  |
| Insulation between supply & battery circuit   | Basic Insulation  |
| Charging time:  | 16 hours  |
| Ambient temperature range:  | 5 to 40°C   |
| Relative humidity:  | Up to 95%   |
| Produced in accordance with:  | EN 60598-1, EN 60598-2-22, EN 55015, EN 61547, EN 61000-3-2, EN 61000-3-3 |
| Technical lifetime (light source):  | > 100000 hours  |
| Weight:   | 459 gr  |
| Degrees of cover protection:  | IP20  |
| Expected battery lifetime:  | 4 years   |
| Controlgear classification in accordance with IEC 62034: with automatic test function |   |
| The controlgear is proof against supply voltage polarity reversal                     |   |
| The controlgear has mains-connected windings of transformer                           |   |
| Light Source: 1 power LED. Model numbers: 3107195, 2210195, wattage: 2.3 ~ 2.5W       |   |

The **Ova/OmniLED R Spot** is a self-contained non-maintained luminaire with selftest function.

### Selftest functions

Every 15 days the luminaire will perform an emergency operation test. This will light the white LED for approximately 3 seconds. The red LED will flash during this test sequence.

Every 6 months the luminaire will perform a battery condition test. The test will last for 60 minutes. The white LED will be lit and the yellow LED will flash during this test sequence.

**Note:** When using DALI or Wireless communication, the frequencies and schedules for tests will instead be determined by the connected PC software.

### Manual test functions

Manual tests can only be performed if both mains and battery are connected.

By pressing the test button briefly (less than 5 seconds) an emergency operation test is performed. The white LED will be lit for approximately 3 seconds, the red LED will flash during this test sequence.

By pressing the test button for between 5 and 10 seconds a battery condition test is performed. This test will last for 60 minutes and can only be performed when the battery is fully charged (steady green LED). The white LED will be lit and the yellow LED will flash during this test sequence.

### Resetting errors

Push the test button for >10 seconds to delete all indicated errors. Then the luminaire enters regular operation mode.

In case that the luminaire no longer meets its rated duration of operation, the battery must be replaced (see chapter "Battery replacement" on page 1).

**Note:** In case of battery replacement, this must be replaced with parts of the same type and characteristics. The replacement must be performed by the manufacturer or a competent person.

**Note:** If the supply cable of the luminaire is damaged, it shall exclusively be replaced by a competent person in order to avoid hazard.