

MODELS

CWST-xx-S5 = Beacon, Shallow Base, W Class, C Class
CWST-xx-S6 = Beacon, Shallow Base, First Fix, W Class, C Class
CWST-xx-W5 = Beacon, Deep Base, W Class, C Class
CWST-xx-W6 = Beacon, Deep Base, First Fix, W Class, C Class

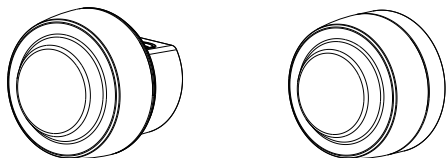

xx Denotes Body & Lens Colour

TECHNICAL INFORMATION

VOLTAGE RANGE (OPERATING) C/W Class	12-29V
VOLTAGE RANGE (EN54-23) C/W Class approved at	12-29V
AVERAGE PEAK CURRENT - C/W Class	37mA @24V
AVERAGE PEAK POWER - C/W Class	0.90W@24V
No. OF STAGES	1
BEACON FLASH RATE	0.5Hz
MONITORING	Reverse polarity
RELATIVE HUMIDITY	Up to 93% (± 3%) - non condensing
WIRE GAUGE FOR TERMINAL	0.5mm ² - 2.5mm ² (max)
OPERATING TEMPERATURE	-25 to +70°C

BASES/IP RATING

Shallow Base (IP21C)

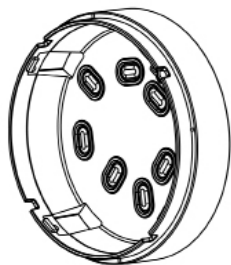

Deep Base (IP65)

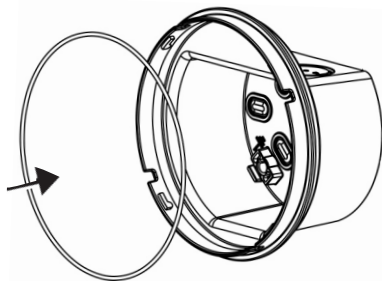

If the Deep Base IP65 option is used, the o-ring seal must be fitted to the base as shown. If required, the deep base gasket accessory can be installed between the base and the mounting surface.

INSTALLATION

STEP 1

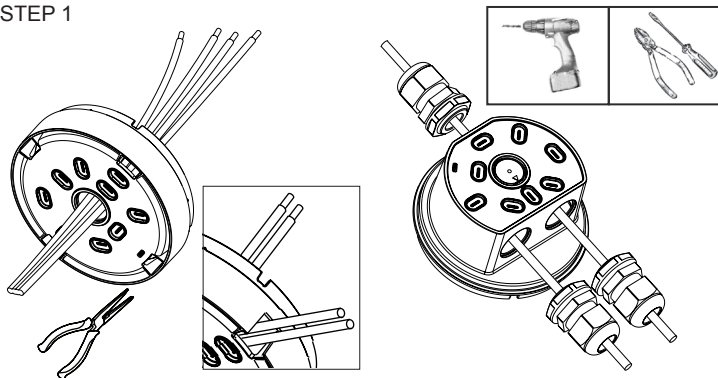

STEP 2 1 - First stage wiring
2 - Second stage wiring

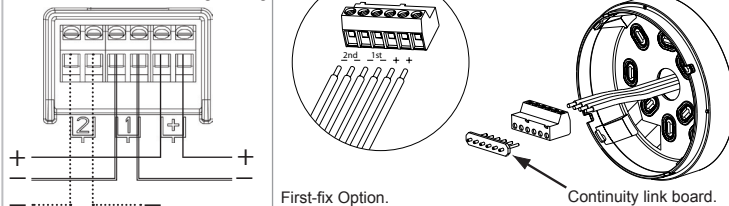

STEP 3

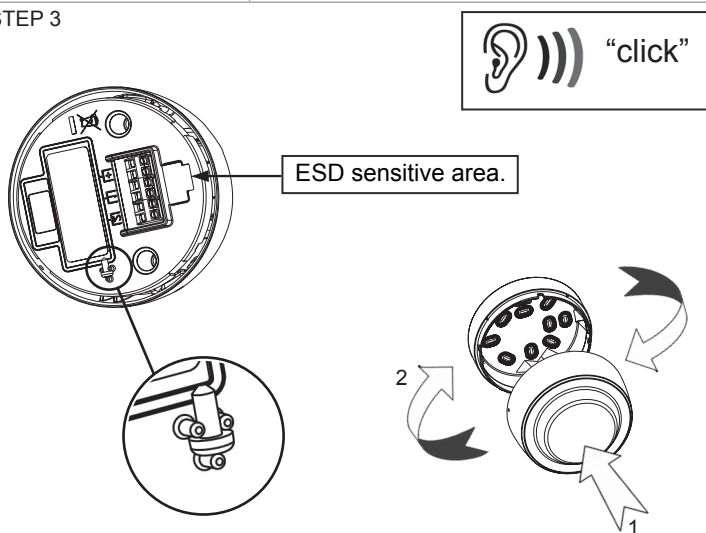

STEP 4

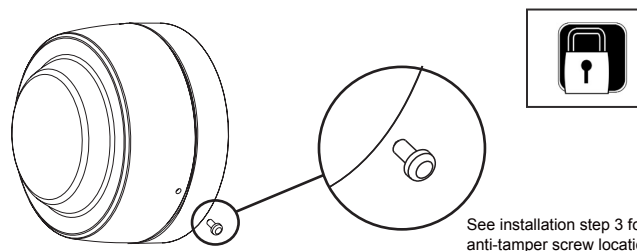

See installation step 3 for anti-tamper screw location.

DIMENSIONS

Shallow and Deep Base

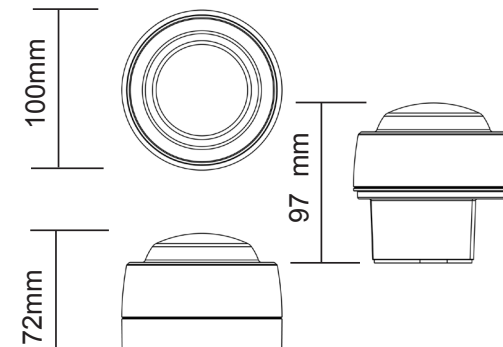

INSTALLATION TIPS

These products are universal devices suitable for wall & ceiling mount installations.

These products are not designed for use with pulsed panel outputs. If more than 1 mode is required use the second stage capability.

Drill out the required mounting and wiring holes in the rear of the base. Do not attempt to "knock-out" the holes with a screwdriver.

Installation tools required: Pliers, Screwdriver, Drill.

Accessories: -

SC076 = 5x Earth Strap/ SC077 = 5x Terminal Block/
SC078 = 5x Installer Link/ P310 = 5x Deep Base O-Ring/
P311 = 5x Deep Base Gasket/ CSR = 5x Shallow Base-Red/
CSW = 5x Shallow Base-White/ CWW=5x IP65 Deep Base-White/
CWR = 5x IP65 Deep Base-Red.

WARNING: Care must be taken when installing first-fix model types with the KAC continuity link board. DO NOT touch the exposed link board contacts when load is applied as this may result in an electrical shock.

This beacon is a single stage device that supports two stage wiring.

WALL & CEILING MOUNT

BEACON MODELS :

CWST-xx-S5
CWST-xx-S6
CWST-xx-W5
CWST-xx-W6

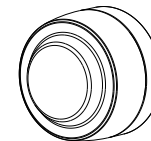

Wall mount device example

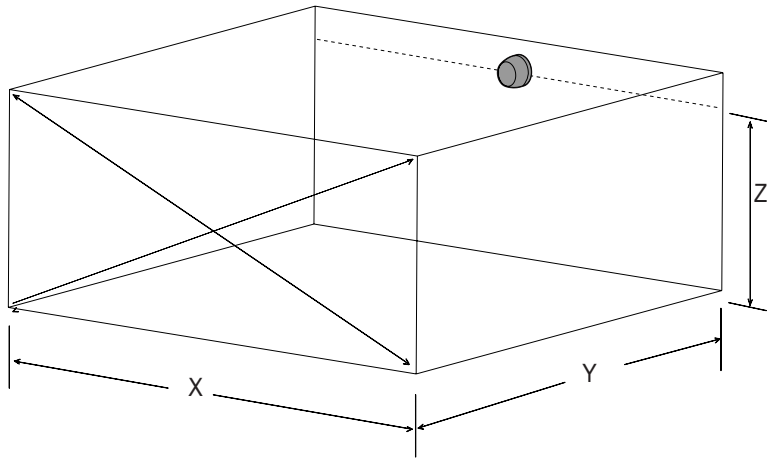

Class of approvals	Device	Led colour	Operating voltage	Installation height (Z)	Coverage cube X-Y (Max)	Approvals classification
W	WMST	WHITE	12V	2.4m	9.1m	W - 2.4 - 9.1
W	WMST	WHITE	24V (NOM)	2.4m	9.1m	W - 2.4 - 9.1
W	WMST	WHITE	30V	2.4m	9.1m	W - 2.4 - 9.1
W	WMST	RED	12V	2.4m	6.2m	W - 2.4 - 6.2
W	WMST	RED	24V (NOM)	2.4m	6.2m	W - 2.4 - 6.2
W	WMST	RED	30V	2.4m	6.2m	W - 2.4 - 6.2

For alternative W class installation parameters all approved coverage's can be seen by downloading the following drawing from the KAC website; 132998_ENSCAPE_EN54-23_W_OUTPUT.pdf

Ceiling mount device example

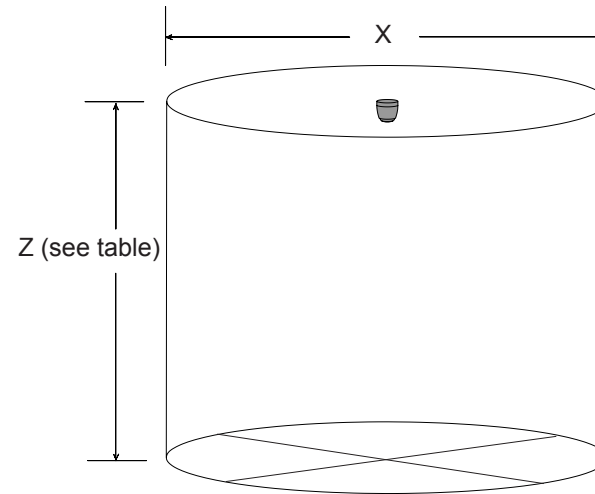

Class of approvals	Device	Led colour	Operating voltage	Installation height (Max)	Coverage cylinder diameter (Max)	Approvals classification
C	WMST	WHITE	12V	3m	10m	C - 3 - 10
C	WMST	WHITE	12V	6m	10m	C - 6 - 10
C	WMST	WHITE	12V	9m	10m	C - 9 - 10
C	WMST	WHITE	30V	3m	10m	C - 3 - 10
C	WMST	WHITE	30V	6m	10m	C - 6 - 10
C	WMST	WHITE	30V	9m	10m	C - 9 - 10
C	WMST	RED	12V	3m	9.3m	C - 3 - 9.3
C	WMST	RED	12V	6m	8.5m	C - 6 - 8.5
C	WMST	RED	30V	3m	9.3m	C - 3 - 9.3
C	WMST	RED	30V	6m	8.5m	C - 6 - 8.5

For alternative C class installation parameters all approved coverage's can be seen by downloading the following drawing from the KAC website; 132997_ENSCAPE_EN54-23_C_OUTPUT.pdf

IMPORTANT NOTES:

Model types using a translucent red or amber lens are not EN54-23 approved. These model types must not be used as visual alarm devices to provide a primary warning notification of fire.

Only products with a clear lens will be EN54:23 approved.

KAC reserve the right to amend the content of this document without prior notice. Pending LPCB approvals.



For CPR Data on all relevant devices please request document D 974